

# RESEARCH NEWS

From the Office of Research and Sponsored Programs - Serving the Research Community of Wright State University

Winter 2006 Vol 36 No 2

201J University Hall Telephone 775-2425



## Early/Start Augmentation Awards Announced

We are pleased to announce the selection of awardees of the Research Challenge Early Start/Augmentation program. Of 51 proposals submitted, 16 projects were funded for a total of \$275,795. The primary objective of the Research Challenge program is to furnish seed funding to faculty in order to produce

additional sponsored research. Congratulations to those receiving an award (listed below) from the November 2005 call for applications. More information on this program may be found at our website: [www.wright.edu/rsp/internal.html](http://www.wright.edu/rsp/internal.html).

<b>Anderson, Liam</b>	Political Science	<i>Power-Sharing in Kirkuk: Avoiding Ethnic Meltdown</i>	\$12,030
<b>Cipollini, Donald F.</b>	Biological Sciences	<i>Microarray Analysis of Garlic Mustard Responses to Herbivory and Pathogen Attack</i>	\$22,000
<b>Duren, Dana L. Bradford Towne</b>	Community Health	<i>Genetics of Childhood Bone Accrual</i>	\$20,504
<b>Fossum, Eric</b>	Chemistry	<i>The Effects of Branching on the Proton Exchange Membrane Behavior of Phase Separated Block Copolymers: A Nanoscale Approach to a Macroscopic Problem</i>	\$20,000
<b>Higgins, Steven R.</b>	Chemistry	<i>An In-situ Method for Lateral Force Calibration in Scanning Probe Microscopes for Investigations of Nanometer-scale Friction</i>	\$22,000
<b>Lauf, Peter K. Norma Adragna-Lauf</b>	Pathology	<i>Structure Function Studies on a Proton Binding Site in a Renal KCC1 Isoform of KCl Cotransport</i>	\$17,750
<b>Leffak, I. Michael</b>	Biochemistry and Molecular Biology (SOM)	<i>Trinucleotide Repeat Expansion &amp; Human Neurodegenerative Disease</i>	\$19,500
<b>Mathies, Bonnie K.</b>	Education and Human Services - Administration	<i>Ohio School Librarians: Dynamic Agents of Learning</i>	\$8,000
<b>Organisciak, Daniel T.</b>	Biochemistry and Molecular Biology (SOM)	<i>Crystalline Migration and Chaperone Properties in Photoreceptors</i>	\$20,630
<b>Patrick, Steve M.</b>	Biochemistry and Molecular Biology (SOM)	<i>Protein Complex Formation and Assembly at Cisplatin Interstrand Cross-links (ICLs)</i>	\$24,381
<b>Pei, Yong</b>	Computer Science and Engineering	<i>Internet2-Based Telepresence</i>	\$15,000
<b>Rigling, Brian D.</b>	Electrical Engineering	<i>Exploitation of Narrow Band, Noncooperative Signals for Dismount Detection and Tracking</i>	\$16,000
<b>Ritzi, Jr., Robert W.</b>	Geological Sciences	<i>Collaborative Research on Reactive Contaminant Transport: Modeling Spatial Cross-Correlation Between Hydraulic and Reactive Aquifer Attributes as Determined by Sedimentary Architecture</i>	\$8,000
<b>Sengupta, Arijit</b>	Information Systems and Operations Management	<i>An Architecture for Secure and Integrated Management of XML and Relational Data</i>	\$21,000
<b>Young, Henry Daniel</b>	Mechanical and Materials Engineering	<i>Scanning Electron Microscopy and Capabilities in Preparation for Integrated Circuit Packaging Research</i>	\$15,000
<b>Zhang, Xinhui</b>	Biomedical, Industrial and Human Factors Engineering	<i>A Quick, Effective Neighborhood Search for Integer Programs and Its Applications in Defense Logistics, Supply Chain Management &amp; Airline Scheduling Problems</i>	\$14,000

## Research Challenge Technology Commercialization Awardees Announced

The Fall 2005 call for applications for the Technology Commercialization Program resulted in the receipt of four proposals, of which all were funded. This program is intended to expand the benefits of Wright State University research accomplishments through commer-

cial application and technology development. **Congratulations** to those receiving an award (listed below). More information on this program may be found at <http://www.wright.edu/rsp/internal.html>.



<b>Cauley, Katherine L.</b>	SOM	<i>HIEx Healthlink Information Exchange</i>	\$19,699
<b>Robert Sweeney</b>	RSCOB		
<b>Krane, Dan E.</b>	COSM	<i>Developing Software that Generates Forensic DNA Profiles and Meaningful Statistics from Mixed Evidence Samples</i>	\$9,007
<b>Teall, Alice</b>	CONH	<i>Clinical Record System</i>	\$19,812
<b>Margaret Clark Graham</b>	CONH		
<b>Bryan Beverly</b>	CTL		
<b>Wooley, Dawn P.</b>	SOM	<i>HIV-1 Treatment Monitoring Assay</i>	\$50,000

## Notes from the AVP

*ERA. Not equal rights amendment. Not earned run average. We are entering the new ERA of Electronic Research Administration.*

It is clearly becoming evident that our quaint internal routing system and home-built databases are no longer interfacing very well with, on the one hand, sponsoring agencies that are going to electronic proposal submission systems, and, on the other hand, the University's new financial management system (Banner). On the pre-award side, the new kid on the block is Grants.gov—the federal portal for grant submissions that is gradually being used by all federal agencies as required by federal law. The most important milestone is February 1, 2007, when all NIH "R01" type applications will need to be submitted through Grants.gov. You will find more about Grants.gov elsewhere in this issue of *Research News*. Currently, we have submitted a



handful of electronic Grants.gov submissions with few or no problems. The volume at this point is quite low, which has allowed us and the PI's the extra time to correct any errors. By February, the volume will have greatly increased, and we will be swamped if we don't find another way.

On the post-award side, the newcomer is SCT/Banner. We have discovered that manually feeding data into Banner and getting information out of it is very time-consuming—so time-consuming, in fact, that we are very much behind in various functions, such as setting up awards in the system. We have hired temporary help but this is not a satisfactory long-term solution.

What is needed is a "system-to-system" solution on both ends to ensure that proposals and awards are moved through the system in a timely manner. Basically this means a web-based workflow system that works automatically with both Grants.gov and with Banner. Fortunately, there are such systems out there. They are expensive, but I don't think we really have a choice at this point. (We are,



though, exploring the possibility of purchasing only some of the "modules" offered and having CATS develop others.)

What does this mean for Principal Investigators? It means that



sometime in the future just about everything connected with the research support process—searching for funding opportunities, preparing and submitting proposals, getting awards set up, accessing financial information during the life of the project—will all be done on line. Gone will be our "yellow sheet" routing slips; gone will be our red folders carried across campus by students who brave wind, sleet and snow while on their appointed rounds.

Welcome to the world of ERA!  
*Bill Sellers*

### Inside This Issue

<i>Notes from the AVP</i>	Pg. 2
<i>Research Challenge Awards</i>	Pg. 2
<i>Pre-Award NOTES</i>	Pg. 3
<i>Sponsor ALERTS</i>	Pg. 3
<i>GRANTS.GOV</i>	Pg. 4
<i>Awards</i>	Pg. 5
<i>Workshops</i>	Pg. 11
<i>Research Challenge RFP</i>	Pg. 12

# Pre-Award NOTES

## NIH, the eRA Commons, Grants.gov, and You



On January 11, 2006, WSU participated in an NIH Videocast that served as an introduction to the electronic grant application process and the SF424 (R&R) cover sheet which will be a part of the proposal submission process through Grants.gov. A number of WSU faculty and RSP staff attended the broadcast; however, for those who were not able to attend and would like to view the videocast, it is archived at <http://videocast.nih.gov/PastEvents.asp?c=998>. A selection of questions submitted during the live sessions were addressed during the training and have been added to the Frequently Asked Questions posted on the Electronic Submission of Grant Applications Frequently Asked Questions Web site at <http://era.nih.gov/ElectronicReceipt/faq.htm>.



Although Grants.gov is a universal portal that will be used to accept applications from all federal agencies in the future, each agency has specific instructions for their applications. If you are required to submit an NIH proposal through Grants.gov, it is imperative that you download both the instructions and the application package available on Grants.gov. The instructions will include specific guidelines for the NIH application process.

Two very important steps in the new NIH process are as follows:

1. In order to submit an NIH proposal through Grants.gov, **the principal investigator must be registered in the NIH eRA Commons**. If you are planning to submit an NIH proposal and are not already registered in the eRA Commons, please contact RSP as soon as possible so that we may enter your information into the Commons. You cannot submit an NIH proposal through Grants.gov

if you are not registered in the NIH eRA Commons.

*(Whether as a new registrant or someone who has already registered in the Commons, be sure that the information in your Commons Personal Profile matches the information entered on the SF424. If these do not agree, the Commons will issue an error message, and the proposal will have to be resubmitted. This was one of the most common mistakes noted in the first required AREA grant electronic submission process.)*

2. Once an application has been received, validated by Grants.gov, and picked up by NIH, **there is a verification process in the eRA Commons that both the principal investigator and the WSU authorized official (RSP) must complete**. If there are errors noted, the application will not be processed by NIH until the errors are corrected. The corrections must be made, and the entire corrected application must be submitted again through Grants.gov by selecting the Changed/Corrected Application Type of Submission. This all must be completed prior to the time and date of the deadline. (This is why it is important to submit the application early so that it will not be marked late and run the risk of being rejected.)

There are additional informative materials (handouts and PowerPoint presentations) on the training page of the NIH Electronic Submission Web site at <http://era.nih.gov/training/ElectronicSubmission/>. We encourage anyone contemplating an electronic submission to NIH in the future to review these materials.



## Sponsor ALERTS

### National Institutes of Health



#### NIH Adjusts Timeline for Electronic Application Submission

On February 7, 2006, NIH issued a notice that the timeline for electronic application submission has been extended to allow additional time before the R01 transition. NIH has adjusted the implementation timeline for electronic application submission to provide an additional four months (one submission round) before the transition of the traditional research grant mechanism (R01) and all subsequent mechanisms. This change sets the new transition date for R01's to February 1, 2007. NIH notes that the new timelines will help both NIH and the applicants by allowing both the additional time to address business process and internal infrastructure changes needed to support the change. NIH will be able to gain more experience through the additional electronic submission cycles and allow them to bring together two major initiatives,

electronic submission and allowing multiple principal investigators on research grant applications.

For a complete updated timeline for NIH electronic



application submission, go to [http://era.nih.gov/ElectronicReceipt/files/Electronic\\_receipt\\_timeline\\_Ext.pdf](http://era.nih.gov/ElectronicReceipt/files/Electronic_receipt_timeline_Ext.pdf).

# GRANTS.GOV

## Transitioning to Electronic Proposal Submission through Grants.gov

RSP is working diligently to make a smooth transition to the electronic submission of federal grant applications through Grants.gov. Use of Grants.gov is being phased in, with different federal agencies requiring different proposals to go through Grants.gov for different deadlines. Some quick reference tips that may help you as you log on to the Grants.gov website are noted below:

- ⇒ Wright State University is registered with Grants.gov and the Central Contractor Registry. (No additional registration by the principal investigator or business manager is necessary).
- ⇒ In order to view guidelines and application packages on Grants.gov, it is necessary to download the PureEdge Viewer for Windows users or the Citrix server for non-Windows users. Both are available as a free download at the Grants.gov website.
- ⇒ Use Internet Explorer when accessing the Grants.gov web site.
- ⇒ Application packages are downloaded and then filled out offline—Grants.gov is not a web-based program.
- ⇒ Each agency has different guidelines and instructions specific to their organization, which may include types and format of files and time of receipt deadline, among others.
- ⇒ If the files you are sending to RSP are larger than 25 MB in total, you may find that they are too big to attach to an email. In this case, you may either copy them to a flash drive or CD-ROM and deliver them to RSP, or you may upload the files to a special FTP site that has been set aside for this purpose. (See instructions under the RSP Grants.gov link located at <http://www.wright.edu/rsp/proposal.html>.)
- ⇒ RSP must submit the finished PureEdge file proposal package to Grants.gov—it cannot be submitted by the investigator.

For more details and updated instructions as they become available in the future, please check our Grants.gov link at <http://www.wright.edu/rsp/proposal.html>.

### *Internal Deadlines* for Grants.gov Proposal Submissions

Basically, Grants.gov is simply a post office box set up to receive federal grant applications. Proposals submitted through Grants.gov must go through a two-step receipt and validation process. The proposal must first go through a screening process at Grants.gov. If critical errors are found at this point, the proposal will be rejected and must be resubmitted. If the proposal passes this first screening at Grants.gov, the federal agency is notified that it is ready for pickup, and the proposal will then go through a screening process at the federal agency. If errors are found at this point, the proposal will have to be corrected and the complete proposal resubmitted through Grants.gov. Therefore, if the proposal is submitted to Grants.gov at the last minute, and it gets rejected by either Grants.gov or the federal agency, it will be very difficult to make the necessary corrections and resubmit the proposal prior to the submission deadline. **Accordingly, it is critical that RSP receives the final proposal for any Grants.gov submissions five (5) days prior to the submission deadline to allow time for any necessary corrections or resubmissions.**



# AWARDS

*The grants and contracts on these pages were awarded from September 2005 through December 2005*

## **College of Education and Human Services**

Bernhardt, Gregory R.

*Project Manager for Expanding the Pool  
of Qualified Teachers (EPQT)*

Ohio Department of Education  
\$103,377

Davis, Stephanie

*Capacity-Building Faculty Support Grant  
FY05*

Ohio Department of Education  
\$105,000

Jung, Notburga R.

*Expanding the Pool of Qualified  
Teachers for Ohio's Schools*

Ohio Department of Education  
\$480,000

Schatmeyer, Kenneth

*The Reading First - Ohio Center*

Cleveland State University  
\$47,000

## **College of Engineering and Computer Science**

Chen, Chien-In Henry

*Performance Improvement of a Receiver  
on a Chip*

Systran Federal Corporation  
\$9,980

Ciarallo, Frank W.

*Innovative Winter Maintenance Material  
Inventory Management and Processes*

Ohio Department of Transportation  
\$123,693

Ciarallo, Frank W.

Rapoch, Terence G.

*Constraint Management in Supply Chain  
Analytics*

NCR Corporation  
\$50,000

Goshtasby, A. Ardeshir

*Incorporation of Advanced Sensor  
Technology to Enable Complex Laser  
Micromachining of Silicon Carbide  
Devices*

Mound Laser and Photonics Center, Inc.  
\$225,000

Grandhi, Ramana V.

*Finite Element Modeling of Human Body  
and Pilot Seat Interactions - Phase II*

General Dynamics  
\$10,000

Hartrum, Thomas C.

*Embedded Implementation of Publish and  
Subscribe for a Communitive Infosphere*

University of Dayton  
\$38,000

Kazimierczuk, Marian K.

Wolff, J. Mitch

*State Technologies Advancement  
Collaborative (STAC)*

Purdue University  
\$98,000

Menart, James A.

*Testing of Cathodic Arc Plasma Sources  
(CAPS) for Magnetohydrodynamic  
(MHD) Control of Hypersonic Flight  
Surfaces*

Acree Technologies, Incorporated  
\$39,000

Mukhopadhyay, Sharmila M.

*Wright Center for Multifunctional  
Polymer Nanomaterials and Devices*

Ohio State University  
\$243,623

Narayanan, Sundaram

*Dynamic Decision Making in Network  
Centric Operations*

General Dynamics  
\$44,796

Narayanan, Sundaram

*User-Centered Design*

LexisNexis  
\$38,688

Narayanan, Sundaram

*Innovation and Entrepreneurship  
Seminar Series*

Dayton Area Graduate Studies Institute  
(DAGSI)

\$12,057

Narayanan, Sundaram

Muller, Amanda C.

*Diverse Data Fusion, Information  
Theory, and Evaluation Techniques*

Anteon Corporation  
\$3,000

Penmetsa, Ravi C.

*Robust Uncertainty Modeling Techniques*

Universal Technology Corporation  
\$37,693

*The staff of the Office of Research and Sponsored Programs congratulates those receiving external funds,  
and we encourage those with unfunded proposals to consult with us about resubmission.*

Quek, Francis <i>Beyond the Talking Head and Animated Icon: Behaviorally Situated Avatars for Tutoring</i> NSF, Miscellaneous \$77,000	Walsh, Charles <i>Wright Center of Innovation for Advanced Data Management and Analysis (WCI-ADMA)</i> Ohio Department of Development \$1,500,000	Jones, Thomas Davidson <i>City of Springfield Satisfaction Survey</i> City of Springfield, Ohio \$3,850	
Reynolds, David B. Phillips, Chandler A. <i>Hand Washer for the Disabled</i> United Rehabilitation Services \$400	Wolff, J. Mitch Mawasha, P. Ruby <i>Ohio Space Grant Consortium Scholars Program</i> Ohio Space Grant Consortium \$21,000	Jones, Thomas Davidson <i>Central Ohio Transit Authority (COTA) Market Survey</i> Lakatos Group \$1,564	
Rigling, Brian D. <i>Waveform Diversity Implementation Study</i> Mission Research Corporation (dba ATK Mission Research) \$33,333	Wolff, J. Mitch <i>Dynamic Test of Pressure Sensors</i> National Aeronautics and Space Administration \$15,000	Jones, Thomas Davidson <i>A Survey of Public Opinion about the Yellow Springs Community</i> Yellow Springs Men's Group \$650	
Rigling, Brian D. Shaw, Arnab K. <i>System Analysis and RF-Floodlight Exploitation of Short-Range GOTCHA Repeaters</i> DoD, Air Force, Air Force Research Laboratory \$7,000	Wolff, J. Mitch Mawasha, P. Ruby <i>Ohio Space Grant Consortium Campus Allocation 2005-06</i> Ohio Space Grant Consortium \$4,000	Jones, Thomas Davidson <i>City of West Carrollton Satisfaction Survey</i> City of West Carrollton, Ohio \$552	
Siferd, Raymond E. <i>RF CMOS Quadrature Oscillator</i> Raytheon Company \$102,200	<b>College of Liberal Arts</b>		
Slater, Joseph C. <i>ISAT Government SEIT Structures Reference Designs and Analytical Models</i> Science Applications International Corporation (SAIC) \$18,289	Dockery, Jane L. <i>Child and Youth Development Initiative: The Community Assessment</i> Montgomery County Family and Children First Council \$25,000	Milligan, Barry E. Engelhardt, Carol M. <i>History and Memory: World War I in British Culture</i> NFAH, National Endowment for the Humanities \$89,654	
Srinivasan, Raghavan Klingbeil, Nathan W. <i>Software for the Design and Certification of Unitized Airframe Components</i> Ohio University \$9,078	Dustin, Jack L. <i>Urban Projects - Urban Universities Linkage</i> Ohio Board of Regents \$40,125	Peck, Dana <i>Partnerships for Success</i> Greene County Family and Children First \$24,500	
	Jones, Patricia D. <i>Ohio Certified Public Manager</i> Ohio Department of Administrative Services \$30,000	<b>College of Nursing and Health</b>	
		Martin, Patricia A. <i>Leadership for an Effective, Regional RN Workforce</i> DHHS, Health Resources and Services Administration \$98,206	
		Martin, Patricia A. <i>Miami Valley Hospital Operating Agreement</i> Miami Valley Hospital \$45,000	

**College of Science and  
Mathematics**

Agrawal, Abinash Amon, James P. Smith, Stephanie Ann <i>Bioremediation of Chlorinated Ethenes in the Constructed Wetlands at Wright- Patterson Air Force Base</i> Air Force Institute of Technology (AFIT) \$100,000	Cipollini, Donald F. <i>Chemical Ecology of Host-Mediated Systemic Interactions Between Pathogens and Insects in Austrian Pine Over a Fertility Gradient</i> Ohio State University \$20,233	Goldstein, David L. <i>RUI: Aquaporins and osmoregulation in a freeze-tolerant amphibian</i> NSF, Research in Undergraduate Institutions \$420,000
Baird, Scott E. Carmichael, Wayne W. Cipollini, Donald F. Grasman, Keith A. Smith, Stephanie Ann <i>Acquisition of Genomics Instrumentation for Evolutionary, Ecological, and Environmental Biology</i> NSF, Major Research Instrumentation (MRI) Program \$382,837	Cipollini, Donald F. <i>Exploring the Potential of Plant Growth Promoting Rhizobacteria to Stimulate Insect Resistance in Plants</i> Ohio State University \$9,063	Hennessy, Michael B. <i>Effects of Chronic Treatment with Antidepressants on Passive Behavior of Isolated Guinea Pigs</i> GlaxoSmithKline \$11,000
Bennett, Kevin B. <i>Human-Machine Interfaces for Coordination Decision Support in Tactical Settings</i> JXT Applications, Inc. \$39,600	Fox, Jane Lee <i>Coupled Models of Planetary Thermospheres/Ionospheres</i> National Aeronautics and Space Administration \$107,041	Look, David C. <i>Materials for High Speed Devices</i> DoD, Air Force, Air Force Research Laboratory \$70,000
Burton, G. Allen <i>An Assessment of Copper Effects on Benthic Invertebrates in Freshwater Ecosystems</i> Rio Tinto \$48,636	Fox, Jane Lee <i>Studies of the Mars Global Surveyor Radio Science Electron Density Profiles</i> National Aeronautics and Space Administration \$76,928	Miller, Corey E. <i>HR Chally Center for the Study of Salespersonship: Statistical Support Fall 2005 - Spring 2006</i> HR Chally \$44,152
Carmichael, Wayne W. <i>Characterization of Cyanobacteria Secondary Metabolites</i> More Than One Source of Support \$7,910	Gilkey, Robert H. <i>Collaborative Research on Multisensory Interaction in Combat Search and Rescue</i> DoD, Air Force, Air Force Research Laboratory \$70,610	Paul, Cassandra C. Baumann, Michael A. <i>License Agreement for AML14 and AML14.3D10 Cell Lines</i> University of Arizona \$1,500
Carmichael, Wayne W. <i>Characterization of Cyanobacteria Secondary Metabolites - Federal</i> More Than One Source of Support \$2,263	Gilpin, Roger K. <i>State of Ohio Sludge Program</i> More Than One Source of Support \$21,367	Petkie, Douglas T. <i>THz Technology and Molecular Interactions (Supplemental)</i> Ohio State University \$13,173
	Gilpin, Roger K. <i>Measurements of Contaminants in Commercial Herbicide</i> ATANOR \$18,638	Petkie, Douglas T. Kamanalu, Sunil <i>Graduate Research Assistant Agreement for Sunil Kamanalu</i> Prime Controls, Inc. \$9,954
	Gilpin, Roger K. <i>Evaluation of Commercial Processes</i> Solutia, Inc. \$10,500	

Pohlman, Roberta L.  
*Center for Health Promotion: MVH Wellness Center*  
 Miami Valley Hospital  
 \$28,285

Ritzi, Jr., Robert W.  
*Ground Water Protection Program 2005*  
 Cemex  
 \$15,000

Shebilske, Wayne L.  
*MOST: Model-based Optimal System for Training*  
 Aptima, Inc.  
 \$60,000

Smith, Stephanie Ann  
*Carbon Metabolism in Photosynthetic Rhizobia*  
 Ohio State University  
 \$9,000

Tarpey, Thaddeus  
*Identifying Placebo Responders in Drug Treated Subjects*  
 DHHS, National Institute of Mental Health (NIMH)  
 \$151,996

Watamaniuk, Scott N. J.  
*Motion Detector Networks for Smooth Pursuit*  
 Smith-Kettlewell Eye Research Institute  
 \$65,141

Watts, Doyle R.  
*Strategic Alliance for the Development of Advanced Remote Sensing Technologies for Effective Water Resources Management in the Western United States*  
 Central State University  
 \$1,599

Wheatly, Michele G.  
 Mawasha, P. Ruby  
*LSAMP Bridge Program*  
 Ohio State University  
 \$12,000

### Lake Campus

Schumm, Gregory F.  
*Targeted Training Grant - AAP St. Mary's Corp*  
 Lorain County Community College  
 \$27,160

Schumm, Gregory F.  
*Targeted Training Grant - Cooper Farms*  
 Lorain County Community College  
 \$7,000

Schumm, Gregory F.  
*Targeted Training Grant - Brawn Industries*  
 Lorain County Community College  
 \$4,300

Schumm, Gregory F.  
*Targeted Training Grant - HCF Management, Inc.*  
 Lorain County Community College  
 \$2,300

### Miscellaneous

Hoffman, Christopher  
*2005 Summer Honors Institute for Gifted Students*  
 Ohio Department of Education  
 \$65,000

Kennedy, Sandra D.  
*Interactive Facilitation and Strategic Action Plan*  
 Veterans Affairs Medical Center  
 \$3,050

Kennedy, Sandra D.  
*Problem-Solving Through Active Listening and Critical Thinking*  
 Veterans Affairs Medical Center  
 \$2,100

Schisler, Cindy  
 Kennedy, Sandra D.  
*Wright State/Southwestern Ohio Labor-Management Working Network Council*  
 Ohio Department of Development  
 \$60,000

Schisler, Cindy  
*The Changing Face of Today's Workforce*  
 Veterans Affairs Medical Center  
 \$1,600

Schisler, Cindy  
*The Changing Face of Today's Workforce*  
 Veterans Affairs Medical Center  
 \$400

### School of Graduate Studies

Sanville, Thomas J.  
*OhioLINK*  
 Ohio Board of Regents  
 \$354,912

Thomas, Jr., Joseph F.  
*Ohio's Research Challenge - "05-07" Biennium*  
 Ohio Board of Regents  
 \$190,550

### School of Medicine

Bernstein, Jack M.  
*Effectiveness of a Novel Treatment of Complicated Skin/Skin Structure Infections*  
 Theravance, Inc.  
 \$0

Binder, Stephen Bruce  
*Pedocrotal Training in Primary Care*  
 DHHS, Health Resources and Services Administration  
 \$138,086

Carlson, Robert G. Falck, Russel S. Wang, Jichuan <i>Crack Cocaine and Health Services Use in Rural Ohio</i> DHHS, National Institute on Drug Abuse (NIDA) \$554,984	D'Agostino, Dominic P. Dean, Jay B. Putnam, Robert W. <i>Real-Time Molecular and Cellular Studies of CNS O<sub>2</sub> Toxicity Using Hyperbaric Atomic Force Microscopy (HAFM)</i> DoD, Office of Naval Research \$87,945	Hangartner, Thomas N. <i>Postmenopausal Evaluation and Risk Reduction</i> Pfizer, Inc. \$16,896
Cauley, Katherine L. <i>Kinship Navigator Consortium</i> Montgomery County Children Services \$95,905	Demerath, Ellen W. Siervogel, Roger M. <i>Telomeres Length as a Marker of Cardiovascular Aging</i> DHHS, National Institute on Aging (NIA) \$71,750	Hangartner, Thomas N. <i>Evaluation of Two Bone-Density Scanners</i> Hologic, Inc. \$3,087
Cauley, Katherine L. <i>Cardiovascular Health and Stroke Prevention Activities</i> Ohio Department of Health \$55,000	Dunn, Margaret M. <i>NCI Award under DCOP Fiscal Agency Agreement</i> Dayton Clinical Oncology Program (DCOP) \$900,046	Hangartner, Thomas N. <i>Evaluation of a Novel Treatment in Patients with Osteogenesis Imperfecta</i> Procter & Gamble Company \$2,075
Cauley, Katherine L. <i>AHEC Support</i> Ohio Board of Regents \$45,182	Dunn, Margaret M. <i>Miscellaneous Awards under DCOP Fiscal Agency Agreement</i> Dayton Clinical Oncology Program (DCOP) \$299,188	Kadakia, Madhavi P. <i>Uptake and Intracellular Transport of Nonomaterials in Yeast Cells</i> AT&T Government Solutions, Inc. \$60,000
Cauley, Katherine L. <i>Women's Health Month - 2006</i> Ohio Department of Health \$8,300	Fyfe, Robert E.W. <i>Center of Excellence in Cellular Dynamics and Engineering</i> Wright Brothers Institute, Inc. (The) \$66,000	Moore, Dennis C. <i>RRTC on Substance Abuse, Disability, and Employment</i> U.S. Department of Education \$699,983
Czerwinski, Stefan Aleksander Demerath, Ellen W. Siervogel, Roger M. Towne, Bradford <i>Genetic Analysis of Osteoporosis Risk Factors</i> DHHS, National Institute of Arthritis and Musculoskeletal and Skin Diseases (NIAMS) \$441,488	Gentile, Julie P. <i>CCOE-MH-ODMH</i> Ohio Department of Mental Health \$75,000	Moore, Dennis C. <i>The Community Health Initiative</i> DHHS, Substance Abuse and Mental Health Services Administration (SAMHSA) \$254,320
Czerwinski, Stefan Aleksander <i>The Drew Diabetes Education Program</i> Montgomery County Combined Health District \$37,000	Hangartner, Thomas N. <i>Pharmacogenetics Research Network and Knowledge Base/WSU</i> Indiana University \$19,690	Moore, Dennis C. <i>Adapting Prevention Education for Youth with Disabilities</i> Ohio Department of Alcohol & Drug Addiction Services \$73,000
		Moore, Dennis C. <i>SARDI Tobacco Prevention in Treatment</i> Miami Valley Health Improvement Council Tobacco Coalition \$24,000

Morris, Mariana

*Role of Angiotensin Receptors in Central Osmosensitivity*

DHHS, National Heart, Lung, and Blood Institute (NHLBI)

\$321,750

Morris, Mariana

Elsed, Khalid M.

*Role of Angiotensin Receptors in Central Osmosensitivity (Minority Supplement)*

DHHS, National Heart, Lung, and Blood Institute (NHLBI)

\$121,975

Morrison, Ann K.

*PROF-COMM-ODMH*

Ohio Department of Mental Health

\$89,000

Organisciak, Daniel T.

*Identification of Therapeutic Agents for AMD Using Selected Models of Retinal Light Damage*

Cleveland Clinic Foundation (The)

\$296,555

Organisciak, Daniel T.

*Antioxidants and Retinal Gene Expression Profiles*

Ohio Lions Eye Research Foundation (OLERF)

\$6,500

Pascoe, John M.

Chumlea, W. Cameron

*Academic Administrative Unit, Pediatrics*

DHHS, Health Resources and Services Administration

\$173,609

Putnam, Robert W.

Dean, Jay B.

*Neural Plasticity During Acclimatization to Hypoxia*

University of California

\$77,278

Rapp, Richard C.

*Cost Effectiveness of Interventions to Reduce Barriers to Drug Abuse Treatment*

University of Arkansas

\$96,759

Remsberg, Karen E.

Siervogel, Roger M.

*Early Life Antecedents of Adult Chronic Disease*

DHHS, National Institute of Diabetes and Digestive and Kidney Diseases (NIDDK)

\$51,548

Saklayen, Mohammad G.

*Novel Treatments for Patients With Kidney Disease*

Amgen, Inc.

\$3,750

Schuster, Richard J.

*Public Health Workforce Scholarship Program*

Ohio State University

\$64,200

Schuster, Richard J.

*Public Health Workforce Curriculum Development and Implementation Program*

Ohio State University

\$38,000

Schuster, Richard J.

*NHLBI Cardiovascular Disease Enhanced Dissemination and Utilization Centers*

DHHS, National Heart, Lung, and Blood Institute (NHLBI)

\$25,000

Sherwood, Richard J.

Duren, Dana L.

Towne, Bradford

*Genetic Architecture of the Baboon Craniofacial Complex*

DHHS, National Institute of Dental and Craniofacial Research (NIDCR)

\$158,874

Sun, Shumei S.

Chumlea, W. Cameron

Siervogel, Roger M.

Towne, Bradford

*Childhood Precursors for Adulthood Metabolic Syndrome*

DHHS, National Institute of Diabetes and Digestive and Kidney Diseases (NIDDK)

\$449,235

Tindall, William N.

*School-Based Asthma Intervention Project*

Ohio Commission on Minority Health

\$87,227

Turchi, John J.

*License Agreement - Turchi*

Trevigen, Inc

\$39

*School of Professional Psychology*

Warfield, Janece

*Child Care Subsidy and Promoting Positive Relationships Program*

U.S. Department of Education

\$66,632

Winfrey, LaPearl

*SOPP Student Practicum Training*

Montgomery County ADAMH Services Board

\$42,000

Winfrey, LaPearl

*Practicum Training*

Employee Care of MVH/Good Sam. Hosp.

\$28,000

Winfrey, LaPearl

*Practicum Training - Professional Psychology Brief Therapy Program*

South Community Mental Health Center

\$28,000

Winfrey, LaPearl  
*Mental Health and Deafness Residency  
Traineeship Program*  
Ohio Department of Mental Health  
\$24,500

Winfrey, LaPearl  
*Pre-Doctoral Training*  
Children's Medical Center (Dayton)  
\$20,000

Winfrey, LaPearl  
*Practicum Training*  
South Community Mental Health Center  
\$14,000

Winfrey, LaPearl  
*Practicum Training*  
Dettmer Hospital  
\$14,000

Winfrey, LaPearl  
*Pre-Doctoral Training*  
Twin Valley Psychiatric System  
\$12,667

Winfrey, LaPearl  
*Practicum Training*  
University of Dayton  
\$12,400

Winfrey, LaPearl  
*Predoctoral Training*  
Dettmer Hospital  
\$10,000

Winfrey, LaPearl  
*Practicum Training*  
Twin Valley Psychiatric System  
\$7,000

Winfrey, LaPearl  
*Practicum Training*  
Bonds, Mathis & Associates  
\$7,000

Winfrey, LaPearl  
*Practicum Training*  
Consumer Advocacy Model Program  
\$7,000

Winfrey, LaPearl  
*Practicum Training*  
Darke County Mental Health Center  
\$7,000

Winfrey, LaPearl  
*Practicum Training*  
Shelby County Counseling Center  
\$7,000

Winfrey, LaPearl  
*Rural Practice Initiative Residency  
Traineeship Program*  
Ohio Department of Mental Health  
\$5,880

Winfrey, LaPearl  
*Urban Public Health Initiative*  
Ohio Department of Mental Health  
\$5,880

Winfrey, LaPearl  
*Practicum Training*  
Cincinnati Center for Developmental  
Disorders  
\$3,000

## RSP WORKSHOPS

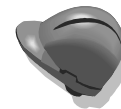

### PROPOSAL WRITING WORKSHOP

The Office of Research and Sponsored Programs is hosting a proposal writing workshop to be presented by Dr. Robert Lucas from the Institute of Scholarly Productivity on Tuesday, April 11, 2006 from 8:30 a.m. to 3:00



p.m. Dr. Lucas is a nationally-known research administrator, teacher, and writer whose humorous and informative style makes him one of the

most popular speakers in his field today.

Dr. Lucas will be sharing his insights about the proposal process, including the following topics:

- How to identify fundable ideas
  - How to locate likely sponsors
  - How to draft a concept paper/foundation inquiry letter
  - How to develop a strong and convincing proposal
  - How to deal positively with reviewers comments
- ...and much more

The workshop is limited to 25 participants, and currently all spaces are filled. If you are interested in attending, however, and would like to be placed on the waiting list, please access the application form on our website at <http://www.wright.edu/rsp> (noted as "Application for Next Workshop" under the "Proposal Preparation" link) and forward it to our office. We will keep you informed as to the status of available spaces.

## Find Funding Sources

RSP will be offering a hands-on session that will provide an introduction to the electronic resources available to faculty and staff for matching research interests with funding opportunities. The workshop will be held in 215 Dunbar Library on Tuesday, March 14, 2006, from 12-1 P.M.. The focus of this workshop is the electronic databases available on the RSP homepage, which includes **Community of Science** and **Sponsored Programs Information**

### Network.

Registration is limited to the first 10 participants so that everyone is assured access to a computer. We ask that those wishing to attend please register by March 10, 2006. For additional information or to register, please contact Jackie Frederick by email at [jackie.frederick@wright.edu](mailto:jackie.frederick@wright.edu) or by telephone at ext. 2664.



## RESEARCH NEWS

Office of Research and  
Sponsored Programs  
Wright State University  
201J University Hall  
Dayton, Ohio 45435  
Voice: 937 775-2425  
FAX: 937 775-3781  
email: [rsp@wright.edu](mailto:rsp@wright.edu)  
<http://www.wright.edu/rsp/>

### Call for Research Challenge Proposals



Dr. Joseph F. Thomas, Jr., Vice President for Research and Dean of the Graduate School has issued a call for proposals for the

#### **Research Challenge Major Collaboration and Infrastructure Grant Program.**

The purpose of this program is to provide funding to encourage the formation of collaborative research teams and the development of proposals for major external grants and contracts.

Copies of the application forms and guidelines, including eligibility information, are available on the RSP web site at

[http://www.wright.edu/rsp/InternalProgs/RC\\_Collab\\_Guide.rtf](http://www.wright.edu/rsp/InternalProgs/RC_Collab_Guide.rtf).

**The deadline for this program is 5:00 p.m. on April 7, 2006.**

The overall Research Challenge program is supported by the Ohio Board of Regents with a view to helping research universities in the State increase their level of external funding, research activity, and technology development.

The Major Collaboration Grant and Infrastructure Program is only one component of the Research Challenge Program.

#### **Assistant Vice President for Research**

William K. Sellers, Ph.D [william.sellers@wright.edu](mailto:william.sellers@wright.edu)

#### **Director, Pre Award**

Ellen Reinsch Friese [ellen.friese@wright.edu](mailto:ellen.friese@wright.edu)

#### **Director, Post Award**

Glen Jones [glen.jones@wright.edu](mailto:glen.jones@wright.edu)

#### **Senior Associate Director**

Eugene Hern, Ph.D [eugene.hern@wright.edu](mailto:eugene.hern@wright.edu)

#### **Associate Director for Technology Transfer**

Isabelle Gorrillot, Sc.D. [isabelle.gorrillot@wright.edu](mailto:isabelle.gorrillot@wright.edu)

#### **Associate Director**

Jackie A. Frederick [jackie.frederick@wright.edu](mailto:jackie.frederick@wright.edu)

#### **Assistant Directors**

Marianne Shreck [marianne.shreck@wright.edu](mailto:marianne.shreck@wright.edu)

M. Wayne Guillory [wayne.guillory@wright.edu](mailto:wayne.guillory@wright.edu)

#### **Grants Accountants**

Danielle Booth [danielle.booth@wright.edu](mailto:danielle.booth@wright.edu)

Gene Florkey [gene.florkey@wright.edu](mailto:gene.florkey@wright.edu)

Keisha Edwards [keisha.edwards@wright.edu](mailto:keisha.edwards@wright.edu)

#### **Administrative Coordinator ( IRB)**

Robyn James, CIM [robyn.james@wright.edu](mailto:robyn.james@wright.edu)

#### **Programs Facilitators**

Cheryl Nickoson [cheryl.nickoson@wright.edu](mailto:cheryl.nickoson@wright.edu)

Jan Power [rsp@wright.edu](mailto:rsp@wright.edu)

Christine Piekkola [christine.piekkola@wright.edu](mailto:christine.piekkola@wright.edu)

#### **Undergraduate Assistants**

Jana Turner

Tiffany Seiter

Stacey Carmichael

Kelly McGhee

Lindsey Irwin

Chris Giannaris

Rachael Brown

## *RSP Staff*